

**Beyond the Limit of Technology**  
**The Best Partner of Global Automakers**



# History of JMP

**2020** Mar. Increase tryout Capacity – 2000Ton Mechanical Press (Bolster Dimension: 6000 X 2500)

**2019** Aug. Purchased HEXAGON 3D SCANNER “AICON STEROSCAN NEO”.

**2018** Mar. Extended Plant & Office (7,206 m<sup>2</sup> ► 13,471m<sup>2</sup>)  
Increased Tryout Capacity(Two 1200Ton Mechanical Presses)

**2014 to 2017** Started business with new customers, such as SLMF, Eagle Bend Magna, Allgaier and PWO  
Plant & Equipment expansion (Tryout Presses & NC Machines)

**2013** Dec. Achieved more than 20 million dollars in overseas business  
Awarded “The honor of a steel tower industry ”by the government

May Moved to the new plant [7,206 m<sup>2</sup>] and installed new equipment  
(Expansion of workplace & 2000 Ton Mechanical Press, 4 NC machines and CMM)

**2007** May Began to work with Mexican stamping companies such as “Metalsa” “Nugar” “CIE Celaya” “Pemsa”, etc.

**2006** June Began to export to European market starting “Doga” Spain “Rubi” Spain, “Magnetto” Italy, etc.  
Mar. Equipment expansion – 1000Ton Hydraulic / Mechanical Presses

**2005** Dec. Started direct transaction with Japan such as “G-Teck” “Press Kogyo Co., Ltd.”  
Sep. Acquired ISO9001 certificate

**2000** Oct. Established JMP Co., Ltd





# About JMP

## 1. Location

JMP is located in Nam-Dong Industrial Complex of Incheon City which is closed to Incheon International Airport. It takes 30 minutes from the Airport to JMP

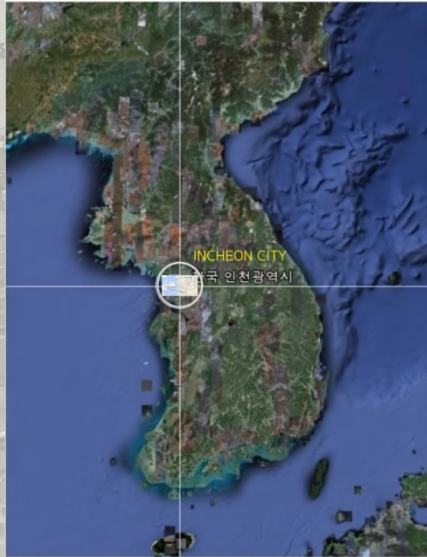

## 2. Sales Department

Director

▶ Adrian Park

Manager

▶ Rocio Kim

Manager

▶ Brad Lee

Project Manager

▶ Lukas Han

Project Manager

▶ Noah Jang

## 3. Contact Point

- Address: 384 Cheongneung – daero, Namdong-gu Incheon, Korea

- T E L : +82-32-712-1011~15

- Email: [Sales@jmpkorea.net](mailto:Sales@jmpkorea.net)

- Web site: [www.jmpkorea.net](http://www.jmpkorea.net)





# Organization

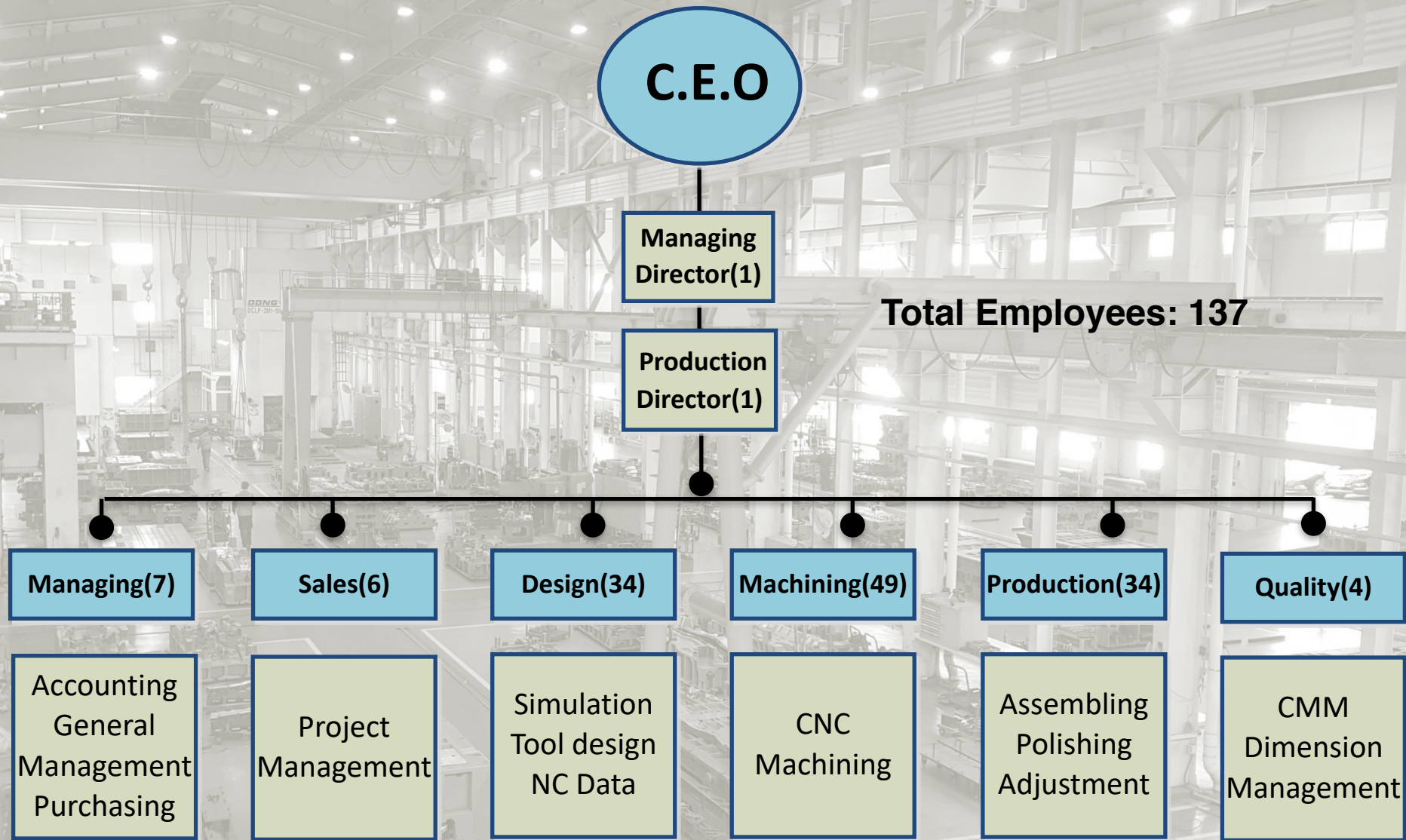



# Main Facility List

EQUIPMENTS		TYPE /CAPACITY	SIZE	MAKER	QTY	TOTAL
TRY-OUT PRESS	MECHANICAL	2,000TON	6,000 x 2,500 x 1,600	FONYU	1	7
		2,000TON	5,400 x 2,500 x 1,600	SIMPAC	1	
		1,000TON	3,600 x 1,900 x 1,400	DONG SHIN	1	
		1,200TON	4,000 x 1,800 x 1,400	SIMPAC	1	
		1,200TON	3,000 x 1,800 x 1,400	SIMPAC	1	
		800 TON	2,300 x 1,250 x 1,400	SIMPAC	1	
	HYDRAULIC	1,000TON	2,000 x 2,000 x 1,200	KEUK DONG	1	
LARGE MACHINING CENTER		RB 2M (3+2 AXIS)	2500 x 1520 x 1350	SNK	1	14
		RB 5M (5 AXIS)	5200 x 3000 x 1800	SNK	1	
		RB-150F (5-AXIS)	3000 x 1500 x 1200	SNK	1	
		DM 100	1600 x 2020 x 1050	HARTFORD	1	
		SW-4260	4120 x 2450 x 890	HARTFORD	1	
		PRO 4210	4040 x 2020 x 950	HARTFORD	1	
		HAS 4210	4260 x 2580 x 1200	HARTFORD	1	
		DBC 4260	4260 x 2650 x 1800	HARTFORD	1	
		VW 5340 (3+2 AXIS)	5030 x 2580 x 1830	HARTFORD	1	
		HB 4210	4260 x 2020 x 1050	HARTFORD	1	
		HB-3210	3210 x 2020 x 950	HARTFORD	1	
		BTD-110 R15	1600 x 1600x 1500	TOSHIBA	1	
		VM84	2000 x 840 x 840	DOOSAN	2	
SMALL MACHINING CENTER		TWIN HEAD MILLING	65 x 700 x 250	CHUO-SEIKI	1	12
		NX 5400	1020 x 540 x 530	DOOSAN	2	
		NX 7500	1900 x 800 x 800	DOOSAN	1	
		DNM-500	1020 x 540 530	DOOSAN	1	
		VM-84	1400 x 700 x 700	DOOSAN	1	
		VM-70	2000 x 800 x 800	DOOSAN	1	
		VM-560	1200 x 540 x 540	DOOSAN	1	
		VM 750L	1900 x 800 x 800	DOOSAN	1	
		NX-6500	650 x 500 x 500	DOOSAN	1	
		VC630 (5 AXIS)	1200 x 540 x 540	DOOSAN	1	
		VCF 850S (5 AXIS)	1900 x 800 x 800	DOOSAN	1	



# Main Facility List

EQUIPMENTS	TYPE /CAPACITY	SIZE		MAKER	QTY	TOTAL
WIRE CUT E.D.M	EZ 15S & (30S)	400(600) x 300 x 250(350)		SPM	2	4
	SP 640P &(740S)	600(700) x 400 x 350		SPM	2	
R/DRILLING MANUAL	BONG SHIN 1.5	1500MM		BONG SHIN	3	6
	NAM BUK 2.0	2000MM		NAM BUK	3	
2D LASER MACHINE	DNE1530FCCX	4,747 x 2,748 x 2,141		FIBER LASER CUTTING	1	1
FEEDER MACHINE	-	0.6T – 6.0T	150-950MM	DAE BONG	1	1
3D SCAN MACHINE	MANUAL	STEREOSCAN NEO R16 FOV550/850		HEXAGON	1	2
	MANUAL	LASER SCAN ARM EDGE 9FT, 7 AXIS(V5)		FARO	1	
CMM	AUTOMATIC	ELECTRONIC OPTICAL SYSTEM	1,500 x 3,000 x 1,000	BROWN & SHARPE	1	2
			1,500 x 3,000 x 1,000	BROWN & SHARPE	1	
CAE/DESIGN (2D/3D)	SIMULATION	VERSION	R8	AUTOFORM	7	7
	UNIGRAPHICS		NX12	-	22	22
	CATIA		R26	-	2	2
	AUTOCAD		LT 2019	-	50	50





# Main Equipment

## (Tryout Presses)



**2000 T Mechanical Press  
(6000 X 2500)**



**2000T Mechanical Press  
(5400 X 2500)**



**1200T Mechanical Press**



**1200T Mechanical Press**



**1000T Mechanical Press**



**800T Mechanical Press**



**1000T Hydraulic Press**





# Main Equipment

## (NC Machining & Etc.)



**CMM**



**(5-AXIS) MACHINING CENTER**



**(3+2AXIS) 5000x2200x1700**



**2D LASER MACHINE**



**3D SCANNER HEXACON AICON**



**E.D.M MACHINE**





# JMP's Business Performance

## T-250/255 Project for GM of Mexico

19 Items (Tandem:12 Progressive: 7) in 2007



Dash Assembly Panel

## DJ-2010 Project parts for Chrysler

22 Items (Tandem: 1 Progressive: 21) in 2008



## FIAT 500 Project - Metalsa

14 Items (Tandem: 6 Progressive: 8) in 2009 - 2010



Crossmember Assy Front



## New Beetle Cabriolet Project - Nugar

19 Items (Tandem: 16 Progressive: 3) in 2010-2011





# JMP's Business Performance

## Volkswagen 361 Faurecia project - Nugar

1 Item for 7 models (Auto Transfer) in 2011



Seat Pan



## GAMMA Project - Metalsa

11 Items (Tandem:3 Progressive: 8)



## Volkswagen A7 Project - Nugar

23 Items (Tandem: 16 Auto Transfer: 1 Progressive: 5)



## D2,DD-DP,DJ Project - Metalsa

51 Items (Tandem: 25 Auto Transfer: 8 Progressive: 18)





# JMP's Business Performance



## P552 Project - Metalsa US

6 Items ( Auto Transfer: 6) in 2013



TRB SIDERAIL INNERS

SIDERAIL OUTERS



## GM GAMMA SUV Project -SLMF

7 Items(Progressive: 6, Tandem:1) in 2014

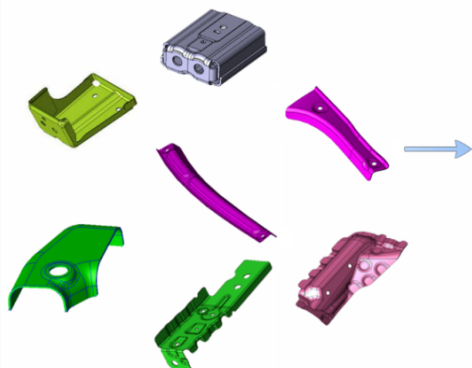

## Avtovaz LADA VESTA Project -LGE

20 items - Tandem in 2014



## Nissan P02F Project - SLMF

8 items (Progressive:6 Transfer: 2) in 2014 - 2015

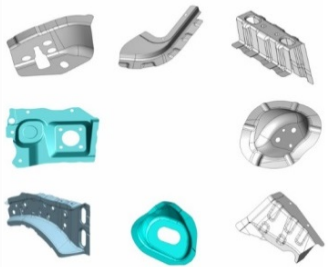



# JMP's Business Performance



## Audi Q5 Project - Allgaier Mexico

8 items (Progressive: 4 Transfer: 4) in 2014 - 2015

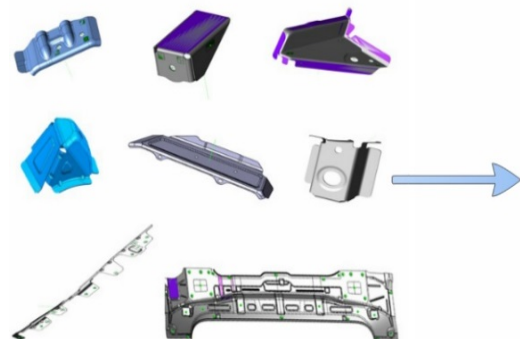

## GM 2DUX Project - SMLF

25 items (Progressive:12 Transfer: 13) in 2015

Transfer



Progressive



## Honda Fit Project -SLMF

10 items (Progressive: 7 Transfer: 3) in 2015

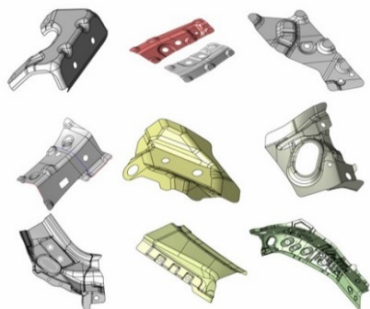

## Volkswagen Crafter Project - Gestamp

9 items (Progressive: 9) in 2015 - 2016

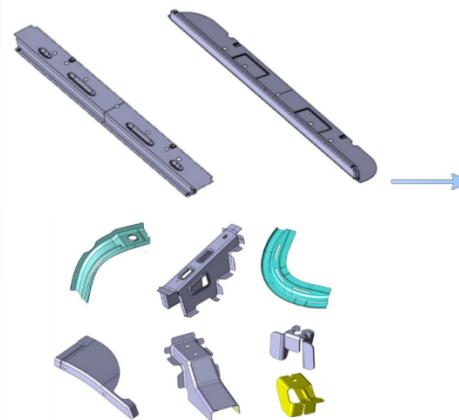



# JMP's Business Performance



## Chrysler DT (Dodge RAM) Project - Metalsa

19 Items (Transfer: 14 Progressive: 5 in 2016 - 2017)

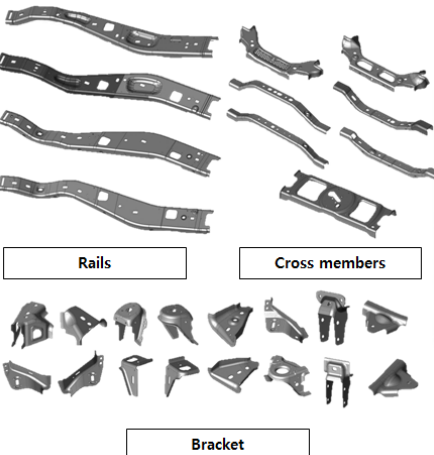

Dodge RAM Pickup



## VW JETTA A7 Project – Nugar(CIE Automotive)

12 Items in 2016 - 2017

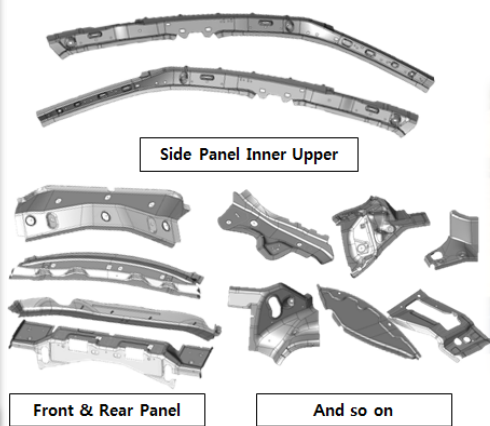

VW JETTA



## Daimler V177 Project – Allgaier & Metalsa

15 Items (Transfer: 8 Progressive: 7) in 2016 - 2017

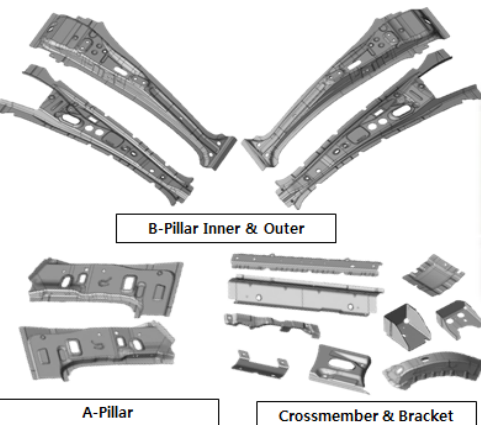

Mercedes Benz A-Class Sedan



## BMW G05 & G2X Project – L&W & Metalsa

5 Items (Transfer: 2 Progressive: 3) in 2016 - 2017

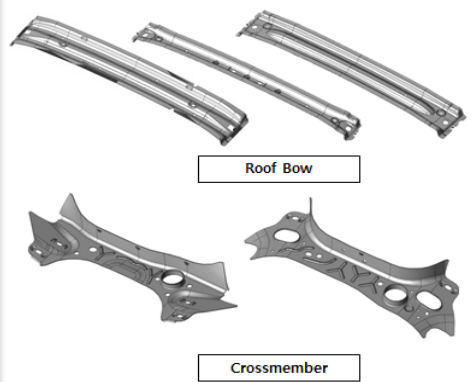

BMW X5



BMW 3 Series





# JMP's Business Performance



## Daimler X247 Project - Allgaier & Metalsa

16 Items (Transfer: 9 Progressive: 7) in 2017 - 2018

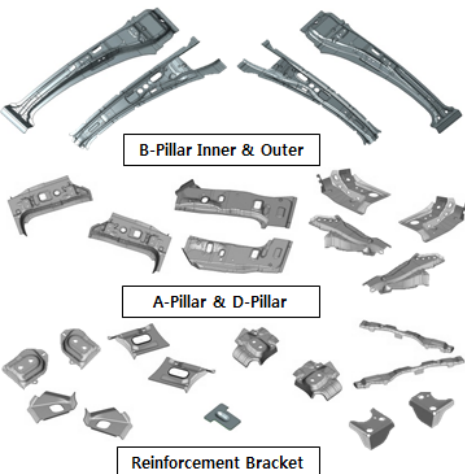

Mercedes Benz G-Class



## Chrysler DJ-D2(Dodge Ram Project) - Metalsa

14 Items (Transfer: 11 Progressive: 3) in 2017 - 2018

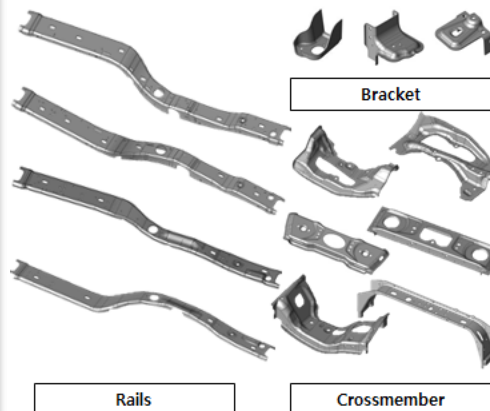

Dodge RAM Pickup



## VW MEB 31 Project – Gestamp

8 Items (Transfer: 1 Progressive: 7) in 2017 - 2018

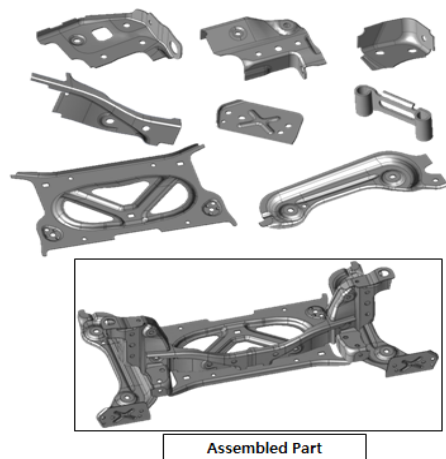

VW Electronic Vehicle I.D.



VW MEB Platform



DAIMLER

## Daimler MRA2, BR223, BR206-Metalsa Germany

5 Items (Transfer: 5) in 2017 & 2018-2019

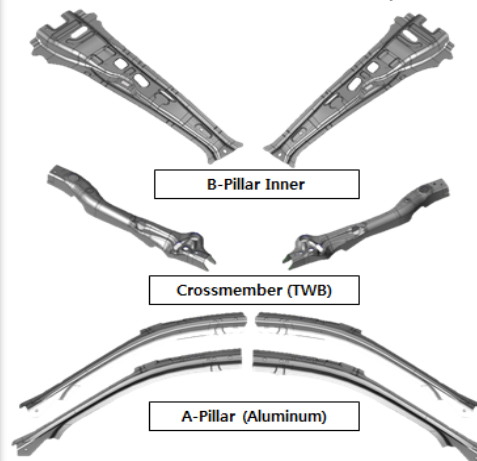

Mercedes Benz C-Class



Mercedes Benz S-Class



# JMP's Business Performance



**GM GEM Project – SLMF MAGNA**  
12 Items (Transfer: 7 Progressive: 5) in 2017-2018



GM CHEVROLET EQUINOX



**VW Atlas Coupe Project – Eagle Bend Magna**  
6 Items (Transfer: 1 Progressive: 5) in 2018 - 2019

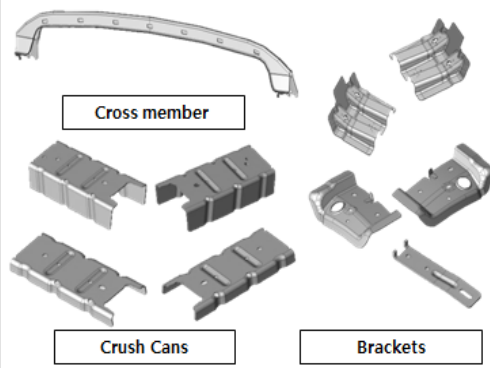

VW Atlas Coupe SUV



**Chrysler JEEP JL Project - Metalsa**  
9 Items (Transfer: 6 Progressive: 3) in 2018 - 2019

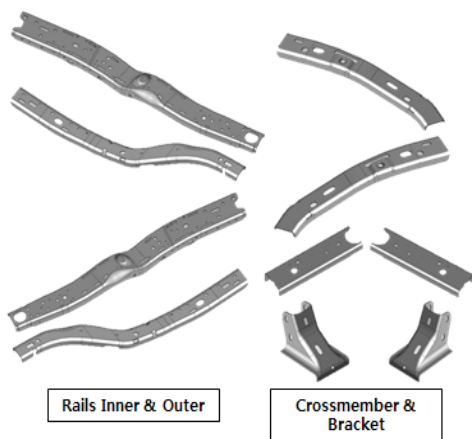

Jeep Wrangler JL



**VW Tarek Project – Nugar (CIE Automotive)**  
16 Items in 2019

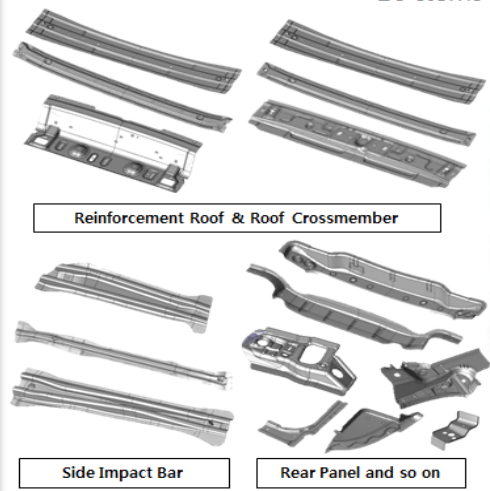

VW Tarek SUV





# JMP's Business Performance



## Chrysler DT TRX(Dodge Ram Project) - Metalsa

17 Items in 2019 - 2020

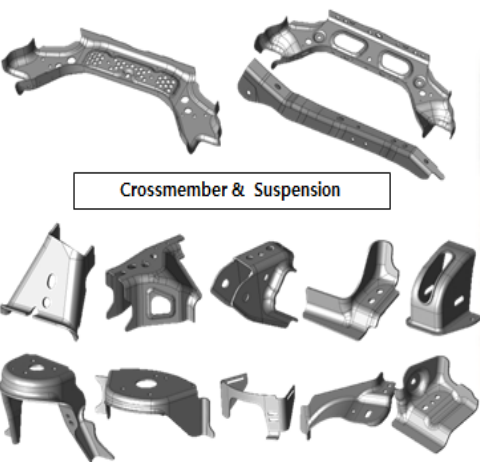

Crossmember & Suspension

Bracket



Chrysler Dodge RAM TRX



## VW Chattanooga I.D.4 Project – Nugar

14 Items in 2020 - 2021

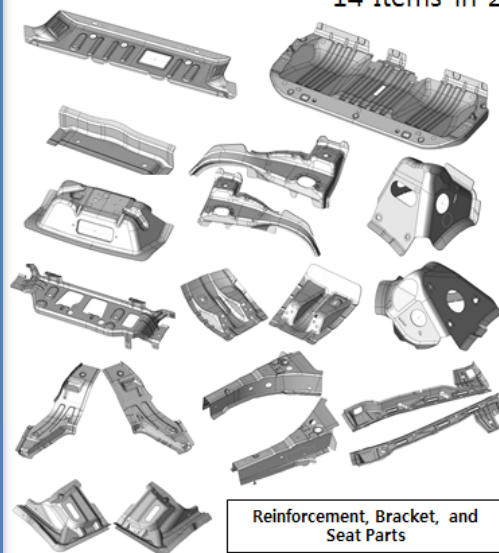

Reinforcement, Bracket, and  
Seat Parts



# Annual Report

## Capacity

Progressive

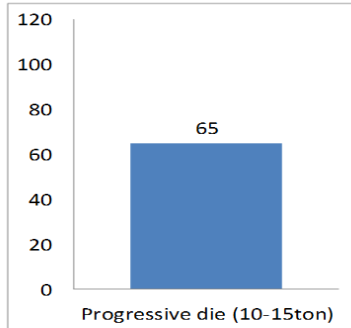

Tandem / Transfer

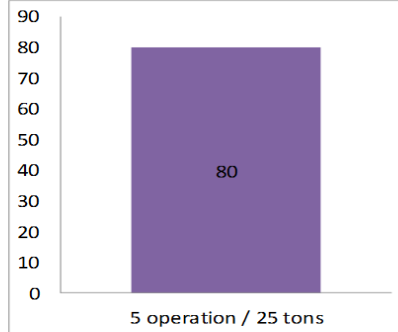

1. Assuming Transfer/Tandem Dies with 5 operations & 25Tons

-Annual Capacity of Production is 75 sets



2. Assuming 10 to 15 Tons of Progressive Die

-Annual Capacity of Production is 65 sets

3. Estimated overall tonnage of manufacturing dies per year is 3500 Ton

## Sales

(Unit: Million US\$ )

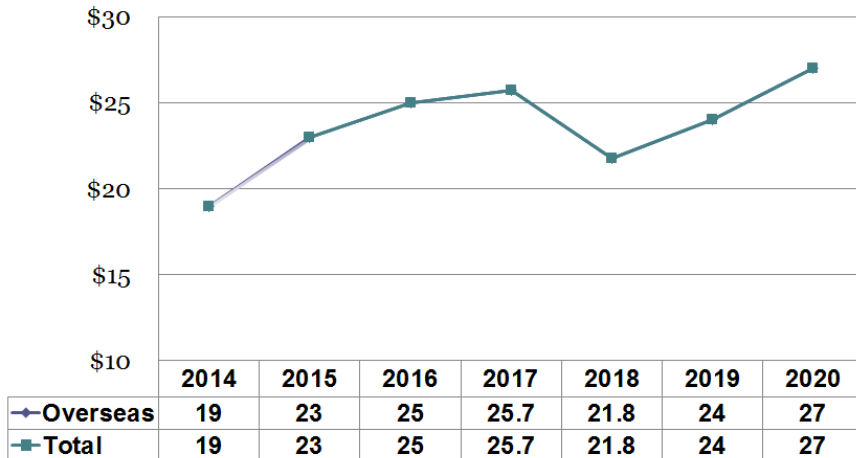

2014. - 19million dollars

2015- 23million dollars

2016- 25million dollars

2017- 25.7million dollars

2018- 21.8million dollars

2019- 24million dollars

2020-27million dollars





# What's JMP's Strength?

---

- **Available all type of dies** - Progressive & Auto / Hand Transfer (Casting & Steel Plate base)
- **Build-Up Type of Process** - Quick Replacement of components
- **Various Experiences**- High Strength steels up to 980, TRB, TWB, Heavy thickness, Aluminum, Etc.
- **Plenty of Equipment** – Optimized Lead-Time
- **Well-Organized & Clean Plant**
- **Easy to communicate with clients**- Spanish & English & German





# Available All type of dies at JMP (Hand transfer Dies)

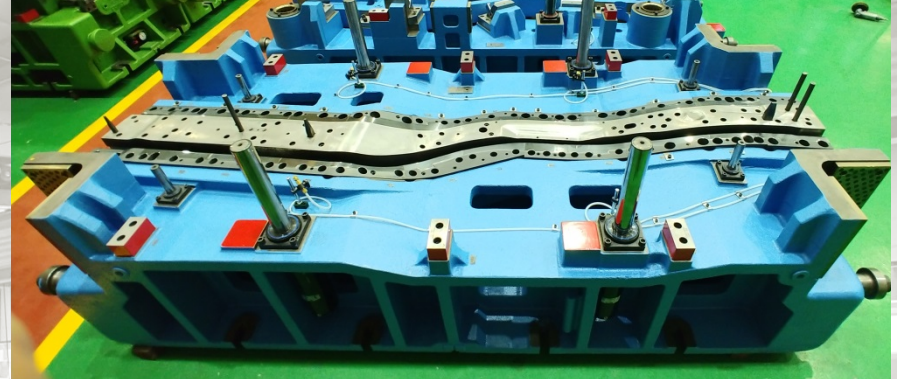



# Available All type of dies at JMP (Progressive Dies)

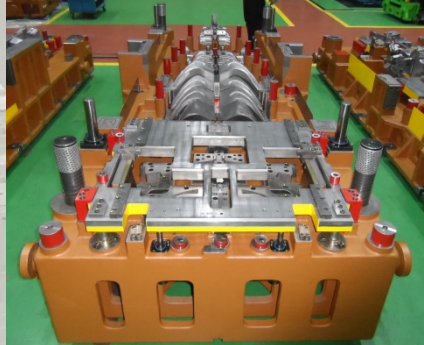
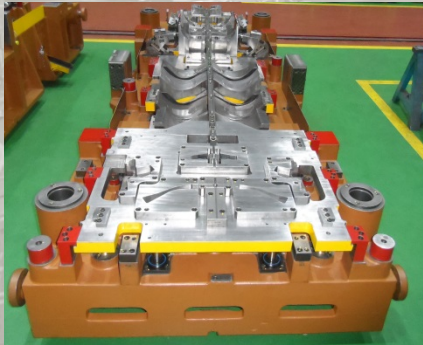
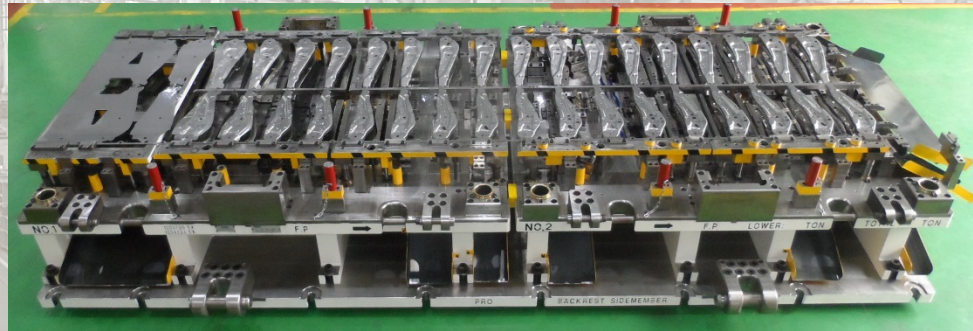
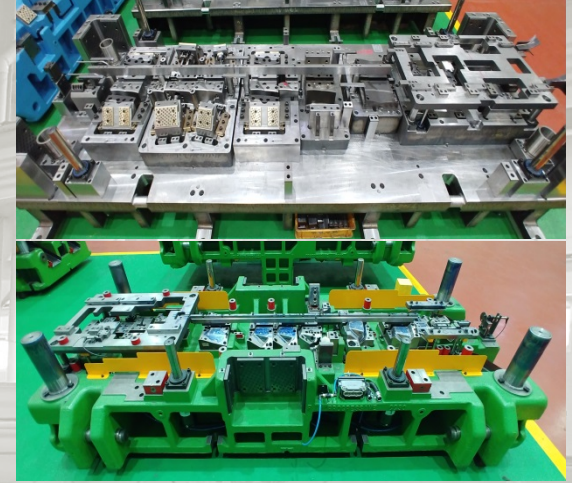
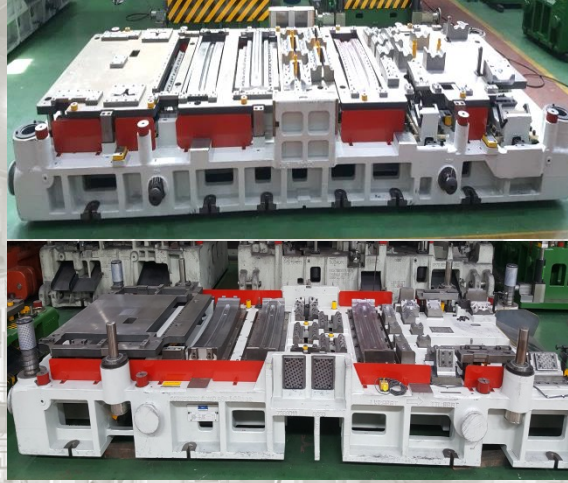
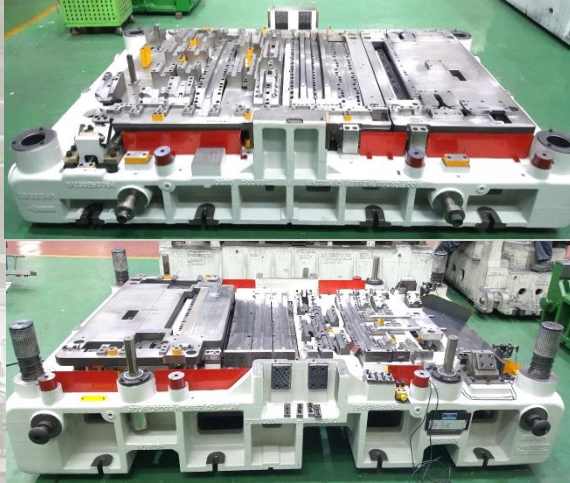



# Available All type of dies at JMP (Transfer Dies)

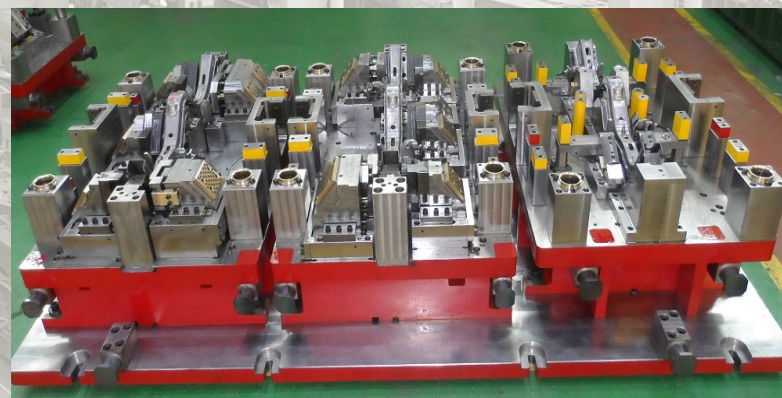
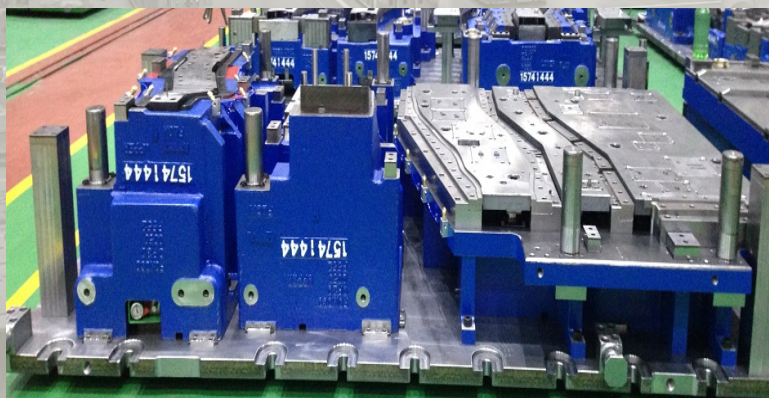
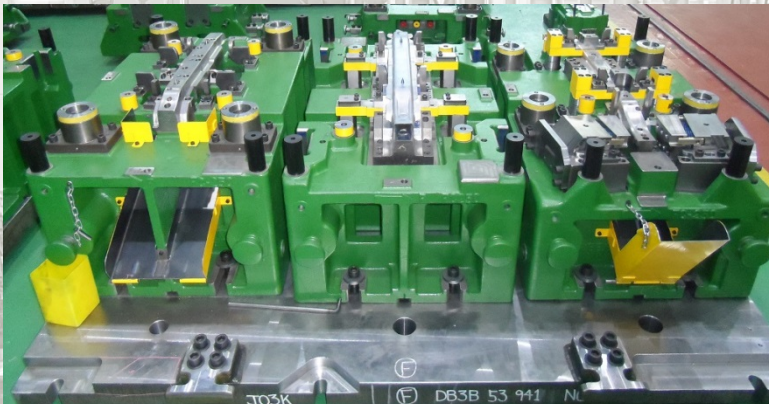
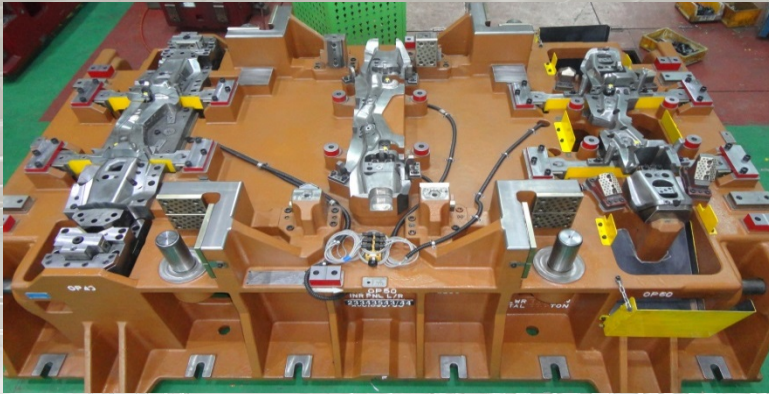



# Various Experiences



Side Impact Bar 980/1.4t

HIGH STRENGTH STEELS



various thickness in one panel

TRB SIDE RAIL INNER

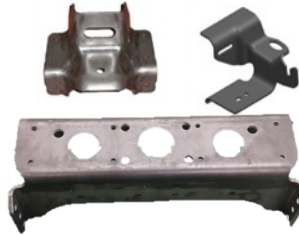

HIGH THICKNESS UP TO 12MM



OIL TANK



RAIL OUTER B-PILLAR L/R



WHEEL HOUSE REAR INR



INTERFACE COVER



DOOR FRAME



REAR FLOOR



RAIL INNER B-PILLAR L/R



CROSS MEMBER



TUNNEL



FRAMES



TRB CROSS MEMBER



TRB SIDE RAIL OUTER



# Various Experiences



CROSS MEMBER



CROSS MEMBER



CROSS MEMBER



REINF. D-PILLAR



REINF. D-PILLAR



REINFORCEMENT, A-PILLAR



REINFORCEMENT, A-PILLAR



REINFORCEMENT CROSSMEMBER



C-PILLAR INNER



DAIMLER X247 B-PILLAR OUTER



DAIMLER X247 B-PILLAR INNER



ROOF BOW C-PILLAR



ROOF BOW REAR





# Well-Organized & Clean Plant (Lay-out)



**Quality Dept.**



**Assembly Area**



**Large Machining Center**



**Tryout & Polishing Area**



**Design Office  
Sales Office**

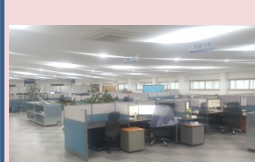

**Small  
Machining  
Center**



**Tryout & Polishing Area**





# Expansion of Plant

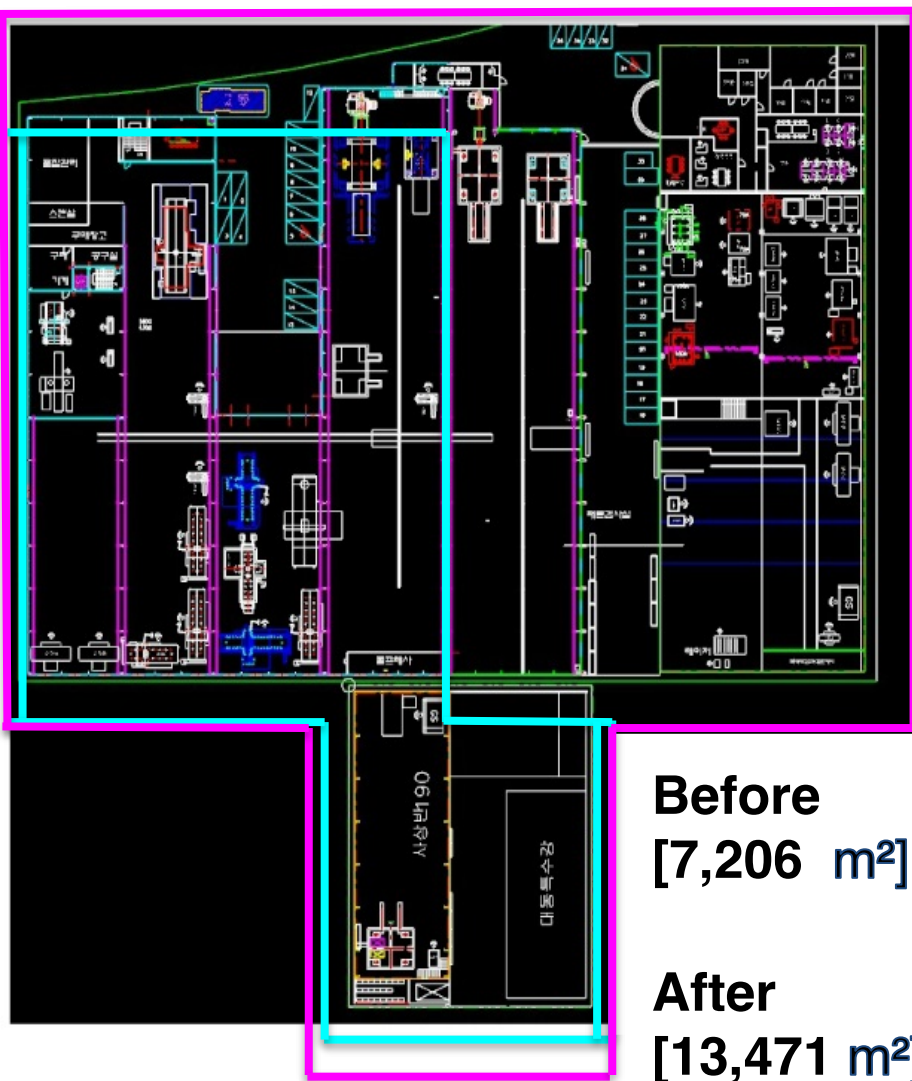

**Before**  
[7,206 m<sup>2</sup>]

**After**  
[13,471 m<sup>2</sup>]

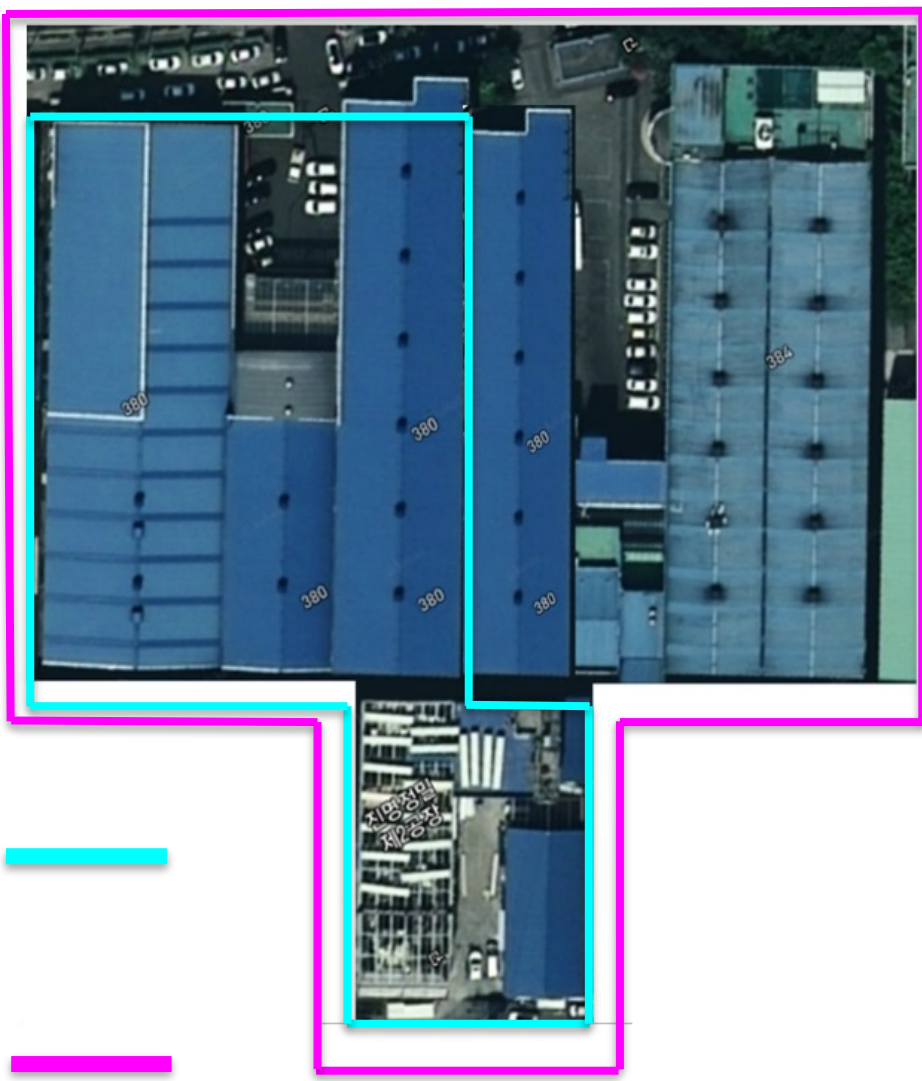



# Main Customers





# Thank you

